

HYDRAULIC CONCEALED DOOR HINGE

Special Tips:

1. When installing this hydraulic hinge, mount the door frame to the wall as firmly as possible to avoid loosening of the door frame after long-term use.
2. When installing this hydraulic hinge, pay attention to the selection of door lock and choose the mechanical lock with lighter lock tongue.

★ Install this hydraulic hinge, the maximum opening angle of the door should not exceed 125 degrees during use, otherwise the hinge and the door body will be damaged

★ Fixed card function: Keep the hinge in open status before installation is completed. Do not remove the card before installation is done, only remove after installation, otherwise the door and hydraulic closure will be damaged.

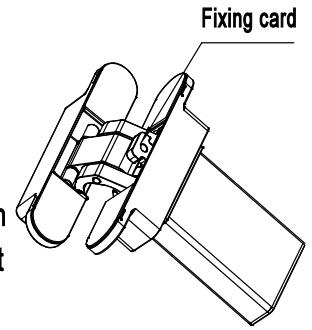

Function diagram:

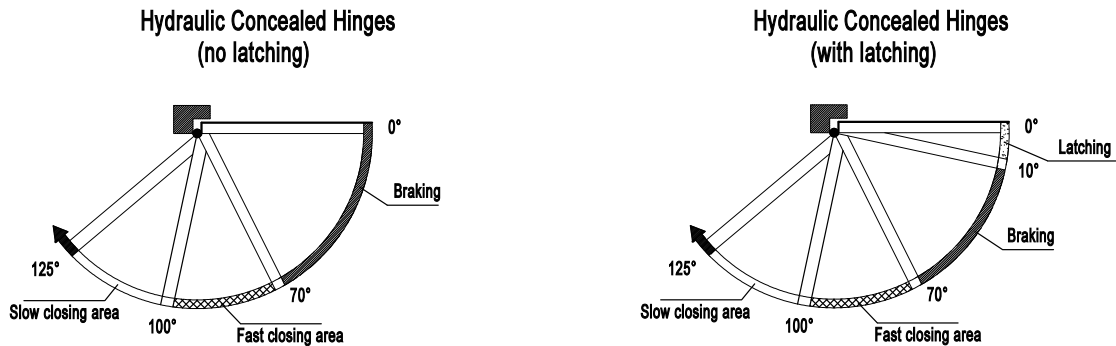

Technical Data:

1. Main material: Zinc alloy, aluminum alloy and SS304
2. Two dimensional adjustable: Left and right $\pm 2.5\text{mm}$, up and down $\pm 2.5\text{mm}$
3. Maximum open angle: 125°
4. No hold open.
5. Closing force: 7N.m
6. Applicable temperature range: $-10^{\circ}\text{C} - 45^{\circ}\text{C}$
7. Service life: 200,000 times

Configuration	Applicable door specifications / types				Optional features	
	Door Weight(kg)	Door Height(mm)	Door Width (mm)	Door Thickness (mm)	Latching	Finish
Hydraulic 1pcs Empty 1pc	30kg	≤ 2200	≤ 850	≥ 42	<input type="checkbox"/> B (with latching) <input type="checkbox"/> W (No latching)	■ Black ■ Gold ■ Silver ■ Grey Note: Other colors can be customized
Hydraulic 2pcs	60kg	≤ 2500	≤ 1000			
Hydraulic 2pcs Empty 1pc	80kg	≤ 2800	≤ 1000			

If the specification of the door exceeds the requirements, please appropriately change or increase the number of hinge specifications to apply, ask the distributor for details.

Dimension:

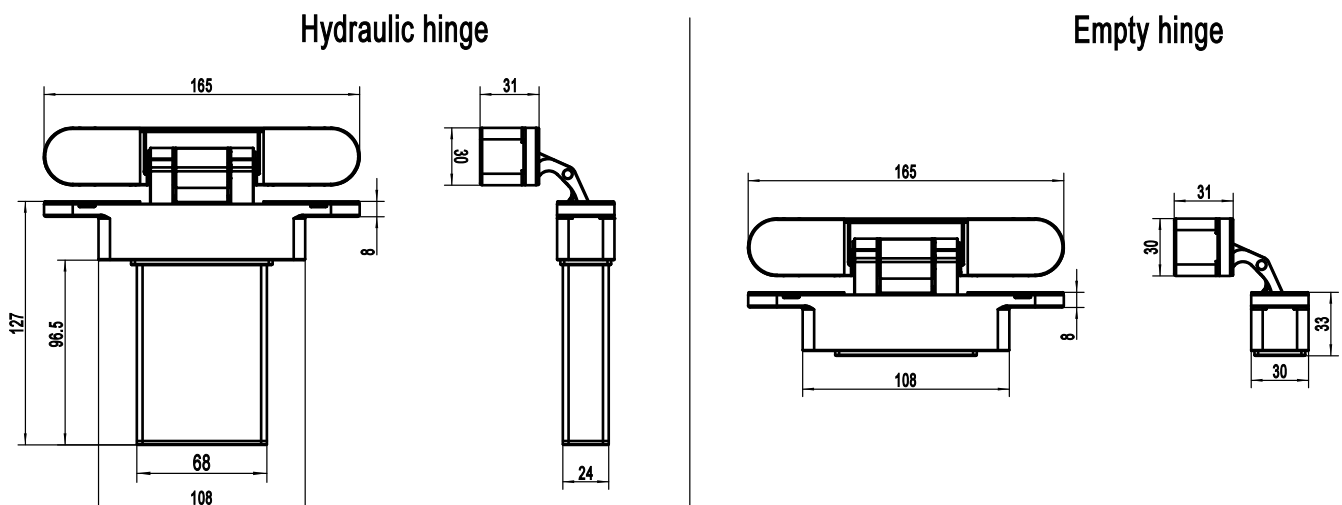

Recommended install position :

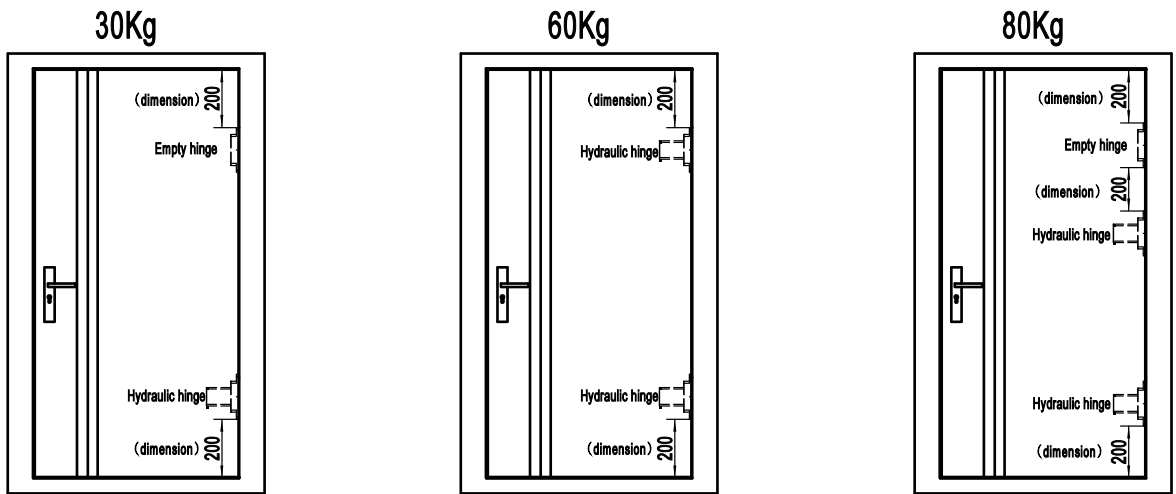

Cutting size: (mm)

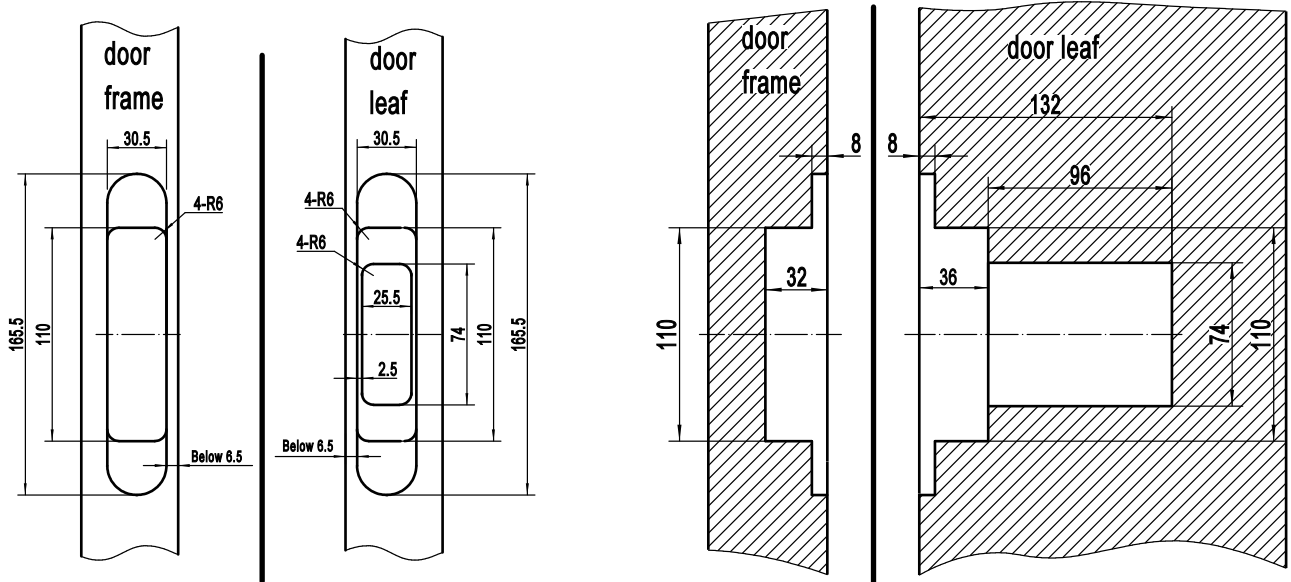

Door leaf position and Closing speed adjustment:

Diagram of the adjustment direction:

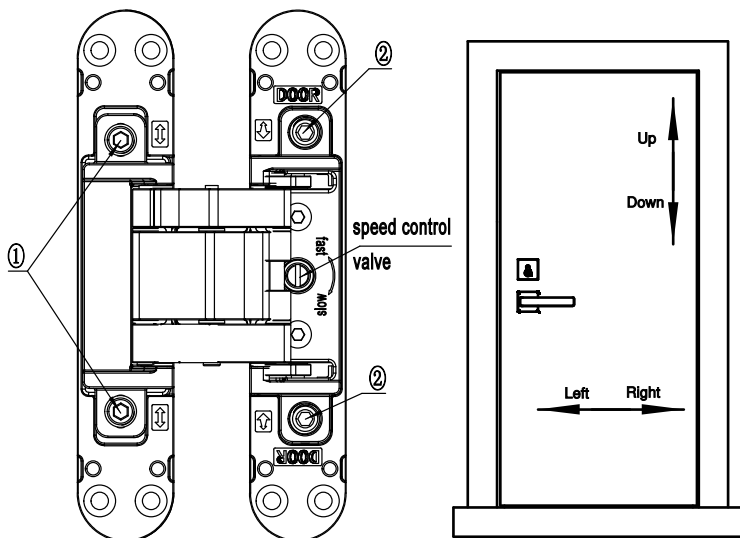

Adjust the instructions:

Screw① is: upper and lower direction adjustment screw, adjustment range $\pm 2.5\text{mm}$.

Screw② is: left and right direction adjustment screw, adjustment range $\pm 2.5\text{mm}$.

Speed control valve: It is recommended at 1 / 10 laps per adjustment

Regulating step:

Up and down direction adjustment:

After releasing the two No① screws with the attached hexagon wrench, adjusting the door to the appropriate height, support the door at the bottom of the door and reset the two No① screws.

Adjust the left and right directions:

Turn the two No② screws in the same direction with the attachment hexagonal. When rotating clockwise, the gap between the door leaf and the door frame becomes larger, and the gap between the door leaf and the door frame becomes smaller when rotating counterclockwise.

Note: always lock all the adjustment screws after the adjustment is completed.